

A Division of Thiessen Products, Inc.

INSTRUCTION SHEET FOR TOOL NO. 5836

JIMS® MILWAUKEE-EIGHT® ROCKER ARM SHAFT KIT

Tools Required

3/8" 12pt Socket
Ft lbs Torque Wrench

Other

Blue Loctite
Assembly Lube



**NOTE: PLEASE READ ALL INSTRUCTIONS COMPLETELY BEFORE PERFORMING ANY WORK!
IF YOU DO NOT KNOW WHAT YOU ARE DOING, DO NOT DO IT!**

No information in this instruction sheet pertaining to motorcycle repair is represented as foolproof or even altogether safe. Even something safe, done incorrectly or incompletely can and will backfire. You and only you are responsible for the safety of your repair work and for you understanding the application and use of repair equipment, components, methods and concepts.

Each and every step this tool is designed to do must be carefully and systematically performed safely by you. All information listed in this instruction sheet has been tested, re-tested and used daily in JIMS® Research and Development Department.

ALWAYS WEAR SAFETY GLASSES OR OTHER FACE AND EYE PROTECTION SUCH AS FULL FACE SHIELD. JIMS® IS NOT RESPONSIBLE FOR DAMAGE, INJURY, OR YOUR WORK. JIMS® IS NOT RESPONSIBLE FOR THE QUALITY AND SAFETY OF YOUR WORK.

1. Remove rocker box cover and rocker box per HD® service manual.
2. Remove rocker arm from stock rocker shaft per HD® service manual.
3. Install the 5836-2 studs (5/16-18 course threads down) into the rocker towers by hand using blue loctite. Screw studs in until they are between .650" and .700" above the flat surface of the rocker tower shown in **Fig 1**. Do not force studs into the head. See **Fig. 2**.
4. Apply a coating of engine oil to the new rocker shaft and inner diameter of the rockershaft bushings.
5. Insert the new rocker shaft into the existing rocker arm. See **Fig. 3**.

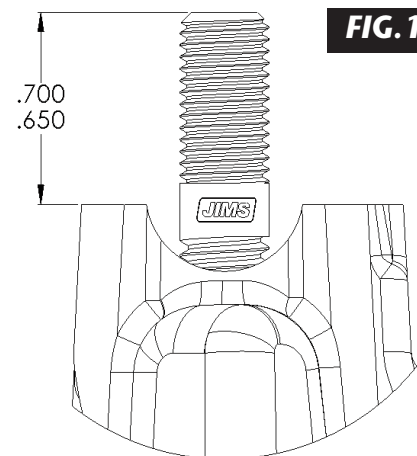

FIG. 1



FIG. 2



FIG. 3

Performance Parts For Harley-Davidson Motorcycles

555 DAWSON DRIVE, CAMARILLO, CA 93012 PHONE 805-482-6913 • FAX 805-482-9224
VISIT US ON THE WEB AT WWW.JIMSUSA.COM



A Division of Thiessen Products, Inc.

INSTRUCTION SHEET FOR TOOL NO. 5836

6. Turn the engine until the lifters are on the base circle of the cam lobe. Carefully align rocker arm shaft with studs and pushrod and carefully lower into place. See Fig. 4

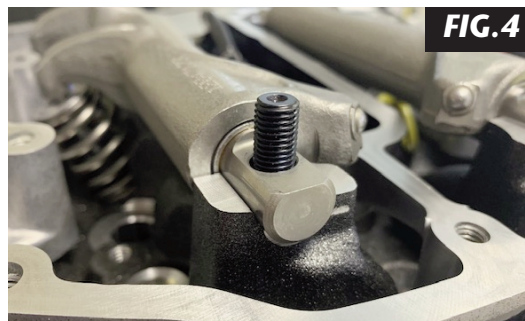

7. Install both 12pt nuts (5836-3) snug on both sides of the rocker shaft. Then torque both to 10 ft lbs, once torqued to 10 ft lbs, torque again to 17 ft lbs, and then again to 23-27 ft lbs for the finishing torque. See Fig. 5.



8. Reinstall rocker box and rocker box cover according to HD® service manual.

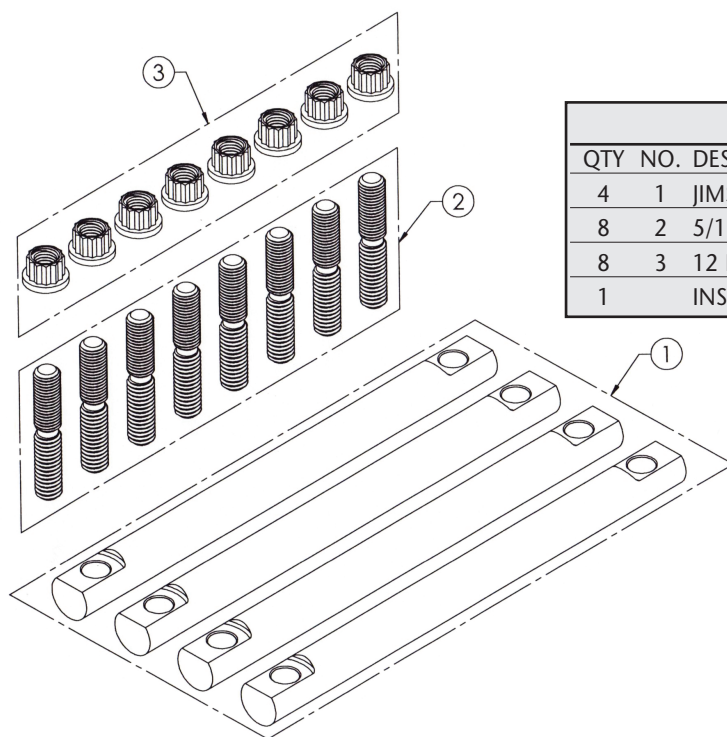

PARTS AVAILABLE SEPARATELY

QTY	NO.	DESCRIPTION	PART NUMBER
4	1	JIMS MILWAUKEE EIGHT ROCKER SHAFT	5836-1
8	2	5/16-24. 5/16-18 X 1-3/4" STUD	5836-2
8	3	12 POINT 5/16-24 NUT	5836-3
1		INSTRUCTION SHEET	5836-IS

CAUTION: WEAR SAFETY GLASSES OVER YOUR EYES.
SEE JIMS® CATALOG FOR HUNDREDS OF TOP QUALITY PROFESSIONAL TOOLS.
THE LAST TOOLS YOU WILL EVER NEED TO BUY.

Performance Parts For Harley-Davidson Motorcycles

555 DAWSON DRIVE, CAMARILLO, CA 93012 PHONE 805-482-6913 • FAX 805-482-9224
 VISIT US ON THE WEB AT WWW.JIMSUSA.COM